

REMOTE GREASE BANK SYSTEM

Equipment maintenance is an important function, but how do you get it all done? Today's modern agricultural equipment can have hundreds of locations requiring grease. Often these grease points are critical components that are tucked into hard-to-reach areas, or covered in dirt. When the weather is right, your equipment needs to be making you money, not held up for maintenance or repair.

Lubecore's Remote Grease Line System brings the grease points to a safe and convenient location on the equipment. No more crawling over and under your machinery to get a grease job done. No more time wasted cleaning away crud just to get access to the grease nipple. With less time required to get the job done, you have the confidence that your equipment is being maintained without sacrificing uptime.

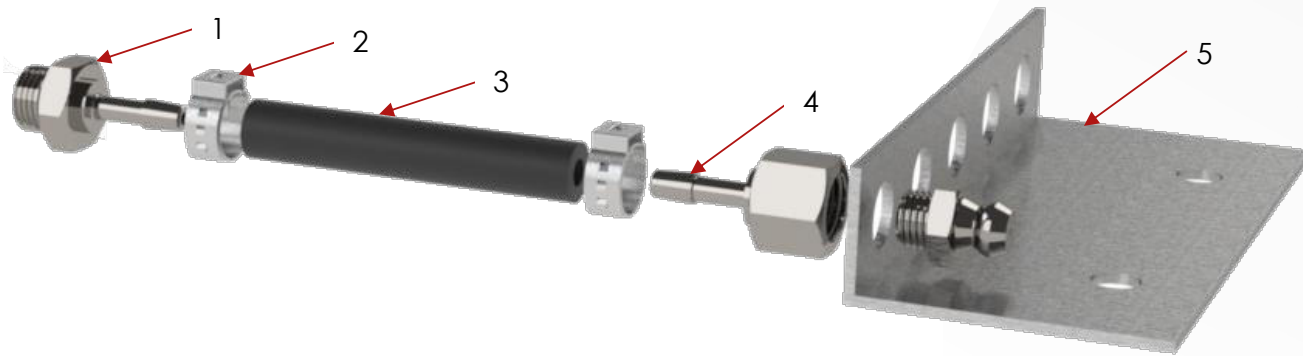

Position	Description
1	Male Threaded Barb Fitting 1/8 NPT
2	Hose Clamp Stainless Steel 8.7mm
3	Korilla Hose – High Pressure Prefilled 8.6mm
4	Female Threaded Barb Fitting 1/8 NPT
5	Remote Line Fitting Bracket

**For more information,
contact us!**

Lubecore International
Inc.
7065 Twiss Road
Campbellville, ON
L0P 1B0, Canada
Tel: 905.864.3110

Lubecore provides a wide selection of grease fitting adapters in both Imperial and Metric threads—to match European and North American equipment. These adapters make routing the remote line in tight spaces a much simpler operation.

I.D.	Part#	Description	Male Thread	Thread Type	Female Thread	Thread Type	Length		Material
			M		F		L		
A1	20.001	90° Cube Connector	1/4 - 28	UNF	1/8 - 28	BSPT	21.0 mm	53/64"	Steel
A2	20.002		1/4 - 28	UNF	1/8 - 28	BSPT	33.0 mm	1-5/16"	Steel
A3	20.003		1/8 - 27	NPT	1/8 - 28	BSPT	25.5 mm	1"	Steel
A4	20.004		1/8 - 27	NPT	1/8 - 28	BSPT	38.3 mm	1-1/2"	Steel
A5	20.005		1/8 - 27	NPT	1/8 - 28	BSPT	51.0 mm	2"	Steel
A6	20.012		1/8 - 27	NPT	1/8 - 28	BSPT	21.0 mm	13/16"	Steel
A7	20.028		M8 - 1.00	Metric	1/8 - 28	BSPT	21.0 mm	53/64"	Steel
A8	20.059		M6 - 1.00	Metric	1/8 - 28	BSPT	19.7 mm	25/32"	Steel
A9	20.060		1/8 - 28	BSPT	1/8 - 28	BSPT	25.5 mm	1"	Steel
A10	20.061		1/8 - 28	BSPT	1/8 - 28	BSPT	38.3 mm	1-1/2"	Steel
A11	20.062		1/8 - 28	BSPT	1/8 - 28	BSPT	51.0 mm	2"	Steel
A12	21.228		1/8 - 27	NPT	1/8 - 27	NPT	25.8 mm	1-1/64"	Brass
A13	35.031		1/8 - 27	NPT	1/8 - 27	NPT	28.0 mm	1-7/64"	Brass
A14	50.593		1/4 - 28	UNF	1/8 - 28	BSPT	21.0 mm	53/64"	Steel
A15	54.347		1/4 - 28	UNF	1/8 - 28	BSPT	21.0 mm	53/64"	Steel
A16	54.348		1/4 - 28	UNF	1/8 - 28	BSPT	33.0 mm	1-5/16"	Steel

